

### TYPICAL INDICATOR ORDERING EXAMPLE

**UB2** **01** **K** **W03** **6CF** — **1JB**

#### Mounting Types

PCB Mounting	
01	Square
Snap-in Mounting	
04	Square

#### Housing

K	Black
---	-------

#### Terminals

W03	Silver PC/Turret
-----	------------------

#### LEDs

##### Bright LED

5C	Red
5D	Amber
5F	Green

##### Super Bright LED

6B	White
6F	Green
6G	Blue

##### Super Bright Bicolor LED

6CF	Red/Green
6DG	Amber/Blue

#### Cap Types & Colors

##### Sculptured Cap Lens/Diffuser Colors

1JB	Clear/White
1JC	Clear/Red
1JD	Clear/Amber
1JF	Clear/Green

##### Beveled Cap & Colors

2B	White
2C	Red
2D	Amber
2F	Green

##### Flat Cap Lens/Diffuser Colors

3JB	Clear/White
3JC	Clear/Red
3JD	Clear/Amber
3JF	Clear/Green

##### Sculptured Cap Lens/Diffuser Color

1JB	Clear/White
-----	-------------

##### Beveled Cap & Color

2B	White
----	-------

##### Flat Cap Lens/Diffuser Color

3JB	Clear/White
-----	-------------

##### Sculptured Cap Lens/Diffuser Color

1JB	Clear/White
-----	-------------

##### Beveled Cap & Color

2B	White
----	-------

##### Flat Cap Lens/Diffuser Color

3JB	Clear/White
-----	-------------

##### Sculptured Cap with Alternating Legend

4JCF	Clear; Red/Green
4JDG	Clear; Amber/Blue

##### Flat Cap with Alternating Legend

5JCF	Clear; Red/Green
5JDG	Clear; Amber/Blue

#### Alternating Legends

11	ON (pos)	OFF (pos)
12	ON (neg)	OFF (neg)
13	START	STOP
14	OPEN	CLOSE

See Part Numbers Table on Next Page

#### DESCRIPTION FOR TYPICAL ORDERING EXAMPLE

**UB201KW036CF-1JB**

Sculptured Cap with Clear Lens, White Diffuser

Red/Green Super Bright Bicolor LED

Square with PCB Mounting



Black Housing

Silver PC/Turret Terminals

Part Numbers for Alternating Legends		
Color	15mm Square Sculptured Cap	15mm Square Flat Cap
	Part Number	Part Number
Red/Green	AT3069JCF11 ~ AT3069JCF14	AT3070JCF11 ~ AT3070JCF14
Amber/Blue	AT3069JDG11 ~ AT3069JDG14	AT3070JDG11 ~ AT3070JDG14

Refer to Ordering Table for Alternating Legend that corresponds with last 2 digits of part number.

**MOUNTING TYPES, SHAPES, & TERMINALS**

**01** PCB Mounting

Square

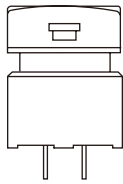

**04** Snap-in Mounting

Square with Built-in Bezel

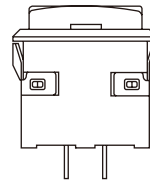

**W03** Terminals

Silver PC/Turret

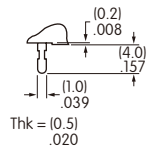

Panel Thickness: .039 ~ .126" (1.0 ~ 3.2mm)

**LED COLORS & SPECIFICATIONS**

The electrical specifications shown are determined at a basic temperature of 25°C. Polarity marks are on the bottom of the device. If the source voltage exceeds the rated voltage, a ballast resistor is required. The resistor value can be calculated by using the formula in the Supplement section. The LED is an integral part of the indicator and not available separately.

Note for Super Bright: 		Bright			Super Bright			Super Bright Bicolor		Unit
		<b>5C</b>	<b>5D</b>	<b>5F</b>	<b>6B</b>	<b>6F</b>	<b>6G</b>	<b>6CF</b>	<b>6DG</b>	
Color		Red	Amber	Green	White	Green	Blue	Red/Green	Amber/Blue	
Maximum Forward Current	$I_{FM}$	30	30	25	20	30	30	30/25 *Amber 25/22	30/30	mA
Typical Forward Current	$I_F$	20	20	20	15	20	20	20/20	15/15	mA
Forward Voltage	$V_F$	1.85	2.0	2.1	3.3	3.5	3.6	2.1/3.5	2.0/2.8	V
Maximum Reverse Voltage	$V_{RM}$	5	5	5	5	5	5	4/4	4/4	V
Current Reduction Rate Above 25°C	$\Delta I_F$	0.40	0.42	0.46	0.25	0.50	0.50	0.40/0.33	0.33/0.33	mA/°C
Ambient Temperature Range		-25° ~ +50			-20° ~ +50			-25° ~ +50	-25° ~ +50	°C

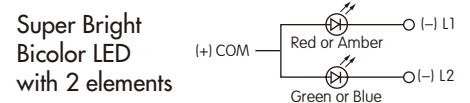
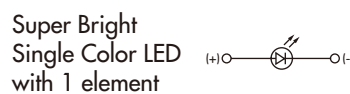

\*Amber color can be achieved by lighting red and green simultaneously on the bicolor LED (not suitable for Alternating Legends).

Toggle  
Rockers  
Pushbuttons  
Illuminated PB  
Programmable  
Keylocks  
Rotaries  
Slides  
Tactiles  
Tilt  
Touch  
Indicators  
Accessories  
Supplement

### CAP TYPES & COLOR COMBINATIONS

**1** AT3074  
Sculptured

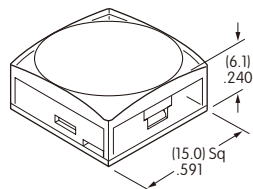

Material: Polycarbonate  
Finish: Glossy

Lens/Diffuser  
Colors  
Available:

- JB** Clear/White
- JC** Clear/Red
- JD** Clear/Amber
- JF** Clear/Green

**2** AT3075  
Beveled

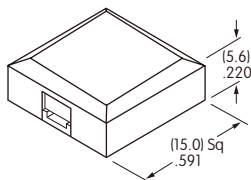

Material: Polycarbonate  
Finish: Glossy

Cap  
Colors  
Available:

- B** White
- C** Red
- D** Amber
- F** Green

**3** AT3076  
Flat

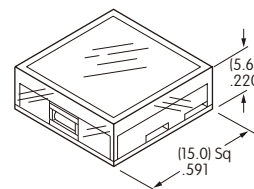

Material: Polycarbonate  
Finish: Glossy

Lens/Diffuser  
Colors  
Available:

- JB** Clear/White
- JC** Clear/Red
- JD** Clear/Amber
- JF** Clear/Green

### Alternating Legend Caps for Super Bright Bicolor LED

AT3069J Sculptured Cap  
with Alternating Legend

- 4JCF** Red/Green
- 4JDG** Amber/Blue

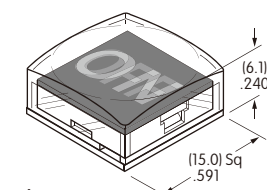

Clear Lens  
Alternating Legend Filter  
Material: Polycarbonate

AT3070J Flat Cap with  
Alternating Legend

- 5JCF** Red/Green
  - 5JDG** Amber/Blue
- Finish: Glossy

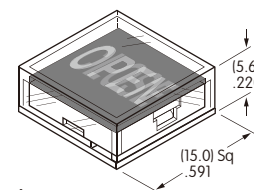

Clear Lens  
Alternating Legend Filter

### Standard Alternating Legend Pairs

- 11** ON OFF  
Green/Red or Blue/Amber
- 12** ON OFF  
Green/Red or Blue/Amber
- 13** START STOP  
Green/Red or Blue/Amber
- 14** OPEN CLOSE  
Green/Red or Blue/Amber

Cap illumination is alternating Green/Red or Blue/Amber; legend text is black. Contact factory for other Alternating Legends.

Legend illustrations are approximate representations of the actual characters on the filters.

Note: Cap Removal Tool available for PCB Mount. See AT093ABC in Accessories & Hardware section for dimensions and other details.

### TYPICAL INDICATOR DIMENSIONS

#### PCB Mount

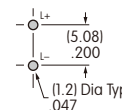
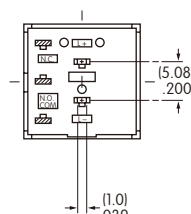
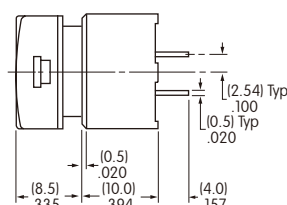
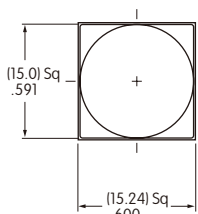

UB201KW035C-1JC

#### Snap-in Mount

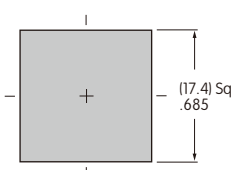
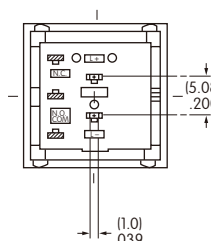
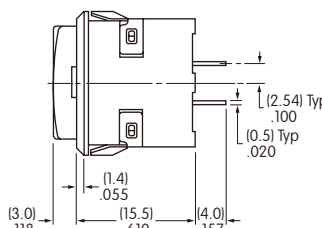
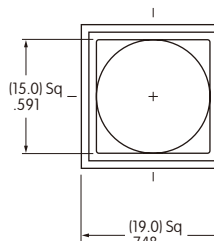

UB204KW035C-1JC

Panel Thickness:  
.039 ~ .126" (1.0 ~ 3.2mm)